

81mm Permanent Split Capacitor

Merkle-Korff Refrigeration Fan Motors — Dependable, Easy to Install & Maintenance Free

Refrigeration product manufacturers rely on dependable, high quality fan motors to keep products running efficiently over long periods of time. These manufacturers have long relied on Merkle-Korff Industries — a company with a 100-year track record of designing and manufacturing motors and gearmotors — to meet their exacting requirements.

Our shaded pole refrigeration fan motors have been designed for the rigors of 24/7 refrigeration applications. Our unique product design features include a bearing/lubrication system and insulation system that provide years of dependable operation. Merkle-Korff commercial refrigeration motors are easy to install, and do not require maintenance during the life of the motor.

Merkle-Korff's low cost global manufacturing platform — with manufacturing facilities on three continents — will provide customers with product value that will meet their most demanding requirements.

Experience all that Merkle-Korff has to offer for refrigeration fan motor applications. Contact us today to learn more.



Features

- -20° to 70°C Oil
- Impedance protection except 16W - auto overload
- Threaded shaft 1/4 - 20, 0.51/0.41" long
- 26-inch lead length with 1/2" bare wire stripped
- Single speed
- Totally enclosed air over (TEAO) designs
- CW or CCW only rotation
- Cast iron construction
- One side pad
- Small nose rotor
- Easy installation

Optional features

- Freezer oil : -40° to -20°C
- Bi-directional CCW/CW
- Custom lead lengths (2" increments)
- Other lead terminations available
- Side pads: none or two
- Large nose rotor

Applications

- Refrigeration
- Food/beverage coolers
- Display cases
- Vending machines
- Walk-in coolers
- Blowers and fans
- Condensing units



Merkle-Korff Industries®

A Kinetek Company®

Merkle-Korff Industries
25 NorthWest Point Blvd., Suite 900
Elk Grove Village, IL 60007
Phone: (847) 439-3760
Fax: (847) 439-3963
Email: sales@merkle-korff.com
Web: www.merkle-korff.com

Dimensional diagram

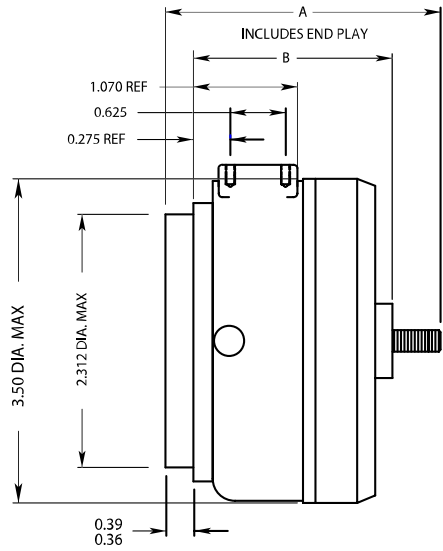

81mm, Permanent Split Capacitor - Totally Enclosed-Cast Iron Frame

Cat. No.	Model #	HP	Volts	Full Load Amps	A (in)	B (in)	Energy Savings Per Year		
							Duty Cycle 100%	Duty Cycle 80%	Duty Cycle 50%
5315	5KPM81HFL0095	5W	115	0.2	3.15	2.36	\$12.40	\$9.92	\$6.20
5325	5KPM81HFL0096	5W	230	0.1	3.15	2.36	\$12.40	\$9.92	\$6.20
5415	5KPM81HFL1086	9W	115	0.3	3.82	2.93	\$13.00	\$10.40	\$6.50
5425	5KPM81HFL1087	9W	230	0.2	3.82	2.93	\$13.00	\$10.40	\$6.50
5815	5KPM81HFL3046S	16W	115	0.6	3.98	3.33	\$28.70	\$22.96	\$14.35
5825	5KPM81HFL3047S	16W	230	0.6	3.98	3.33	\$28.70	\$22.96	\$14.35

Saving claims based on estimates (versus shaded-pole) on full load at 1550 RPM, \$0.08/KWH, and system savings equal to 1.75 X motor savings due to reduced heat load on compressor.

